

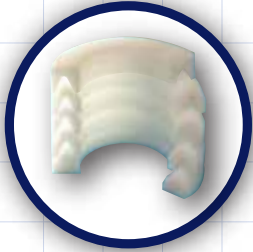

# 1860 Series: Control Valve - Stem Packing Sets



## 1860 SERIES

Configured for commonly used control valves, these molded PTFE sets consist of (3) "V"-rings, (1) "M"-ring, (1) "F"-ring and a wiper ring. For lower operating pressure the thinner "legs" of this higher profile design allows for sealing with less compression of the packing set. Our V-Ring packings are suitable for most applications. Component parts are available separately for custom configurations.

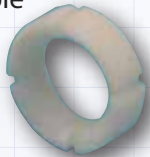

wiper ring

Set Part #:	1860-0375	1860-0500	1860-0750	1860-1000	1860-1250
Configuration:	F/3V/M+Wiper	F/3V/M+Wiper	F/3V/M+Wiper	F/3V/M+Wiper	F/3V/M+Wiper
Stem Diameter:	3/8"	1/2"	3/4"	1"	1-1/4"
Packing Set - ID x OD:	3/8" x 7/8"	1/2" x 1"	3/4" x 1-3/8"	1" x 1-3/4"	1-1/4" x 2"
Packing Set - Height:	.900"	.950"	1.200"	1.420"	1.350"
Wiper Ring - ID x OD:	3/8" x 5/8"	1/2" x 3/4"	3/4" x 1"	1" x 1-1/2"	1-1/4" x 1-3/4"
Wiper Ring - Height:	.250"	.275"	.285"	.285"	.285"

Desc	Component #:	Component #:	Component #:	Component #:	Component #:
"F" - Ring:	825-19F	825-33F	825-57F	825-76F	825-88F
"M" - Ring:	825-19M	825-33M	825-57M	825-76M	825-88M
"V" - Ring:	825-19V	825-33V	825-57V	825-76V	825-88V
"Wiper" - Ring:	1860W-0375	1860W-0500	1860W-0750	1860W-1000	1860W-1250

Note: All dimensions are nominal/reference

### HAVE A CUSTOM SIZE OR CONFIGURATION?

please contact us directly for a quotation.



- ▶ V-Ring Packing Sets
- ▶ ID down to 1/4"
- ▶ OD up to 4"
- ▶ Prime Grade PTFE filled and unfilled resins

 Shown Above: **A)** F/4V/M/wiper **B)** V-Rings Thicker Height **C)** V-Rings Thinner Height

**Question?**  
Please contact us directly for more information



773.282.3787



773.282.2333



contact@parksideind.com

 Click our new website [www.parksideind.com](http://www.parksideind.com)